

# MONTÁŽNÍ NÁVOD

## LAMBDA

VÝŠKOVĚ STAVITELNÁ PODNOŽ S DVĚMA  
ELEKTROMOTORY A MOŽNOSTÍ BLUETHOOT



LAMBDA



LAMBDA BT

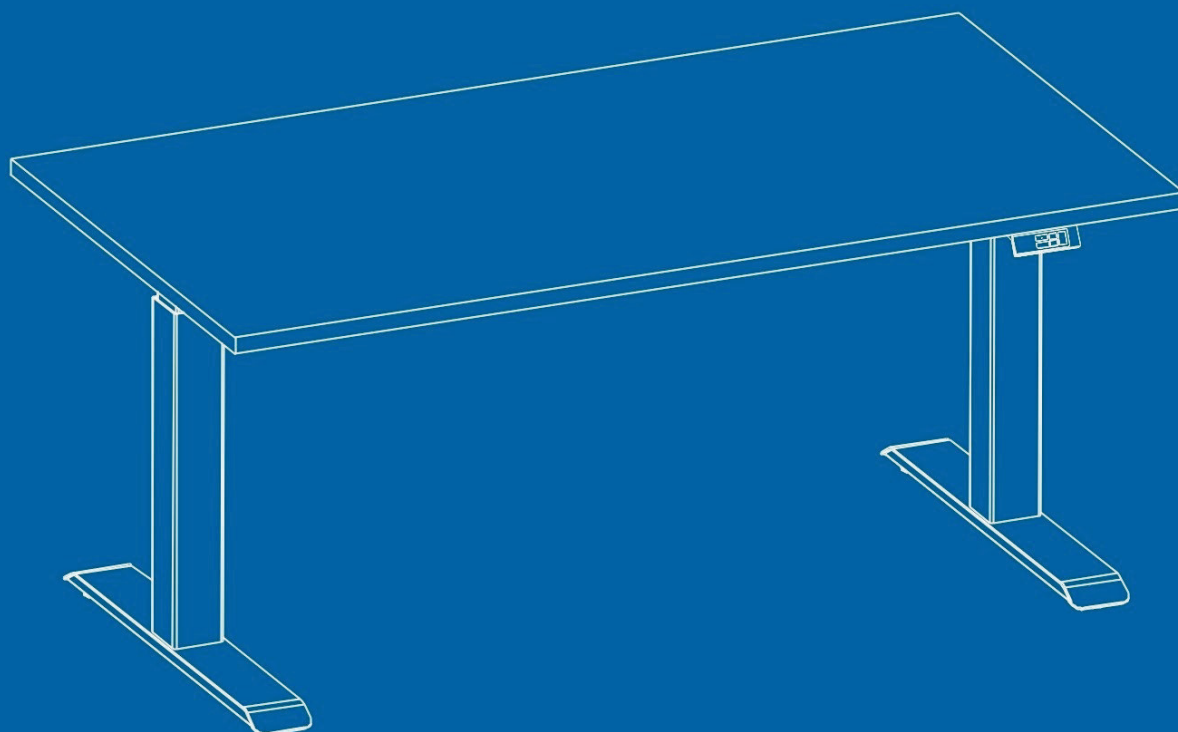

# DÍLY A NÁŘADÍ

Č.	NÁZEV	KS
1	Sloupek (noha)	2
2	Retifikační šroub	4
3	Dolní příčka	2
4	Šroub M8x16	8
5	Horní příčka	2
6	Šroub M6x10	4
7	Spojovací nosník	1
8	Imbusový klíč 4mm	1
9	Imbusový klíč 5mm	1
10	Šroub M6x12	12
11	Šroub M6x16	4
12	Gumová podložka	10
13	Vrut ST3.5x19	7
14	Vrut ST4.8x19	12
15	Příchytka kabelů	5
16	Control box	1
17	Ovladač	1
18	Napájecí kabel	1

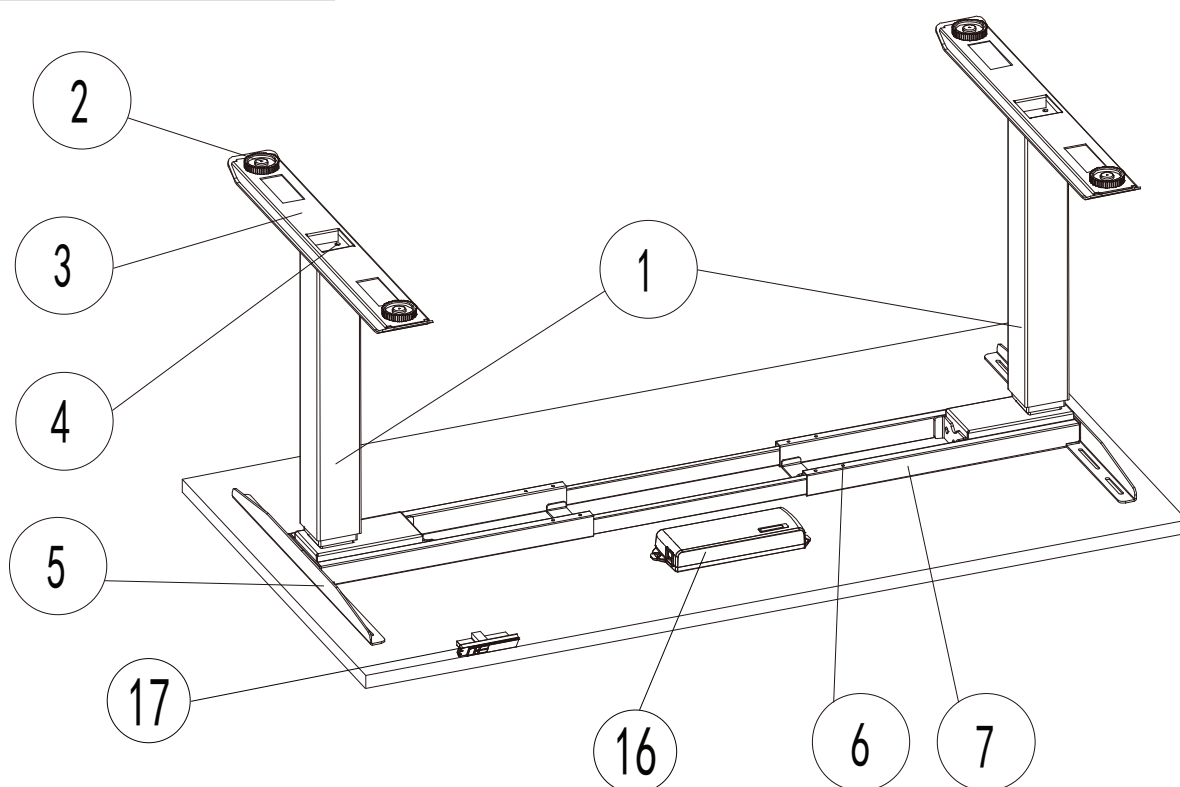
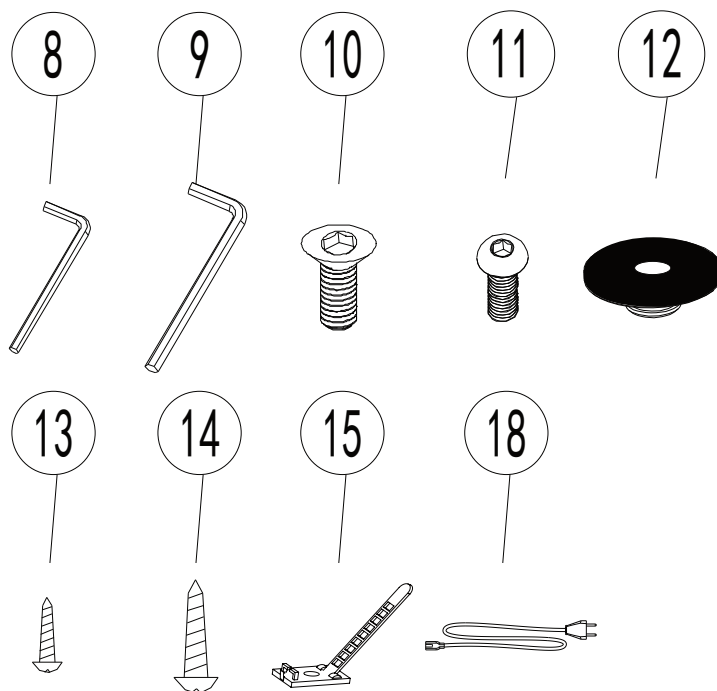

# 1.KROK

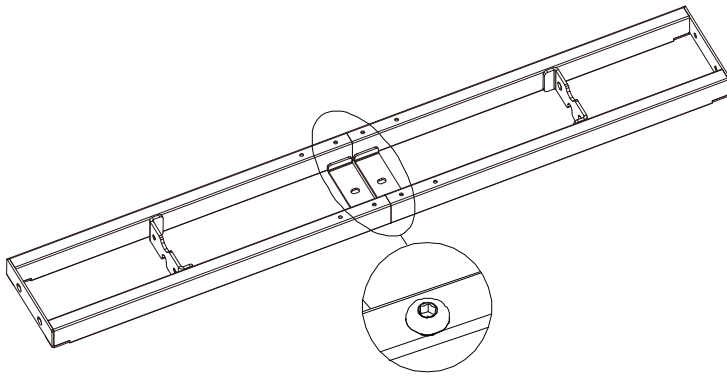

**IMBUSOVÝ KLÍČ 4MM**

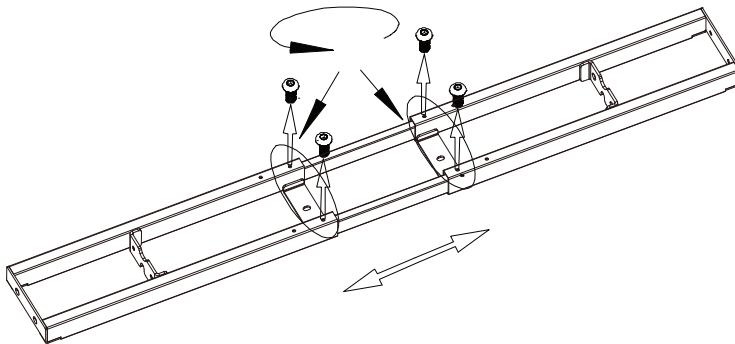

**IMBUSOVÝ KLÍČ 4MM**

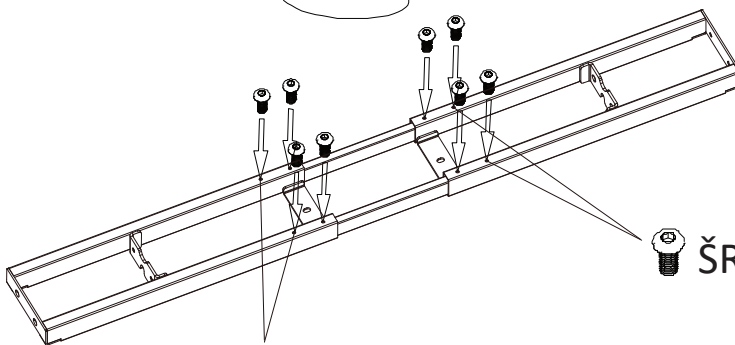

 **ŠROUB M6x10 2ks**

 **ŠROUB M6x10 2ks**

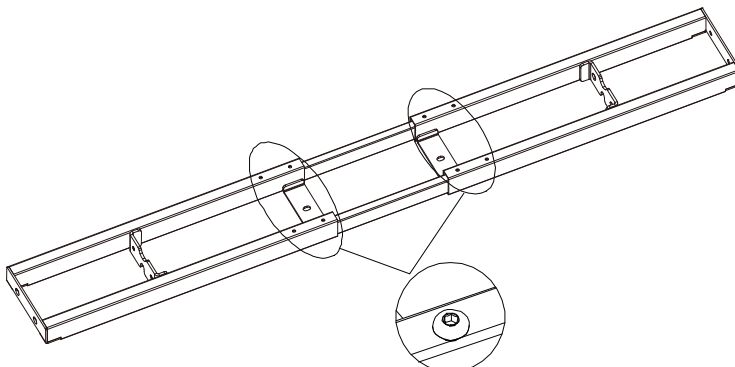

## 2.KROK

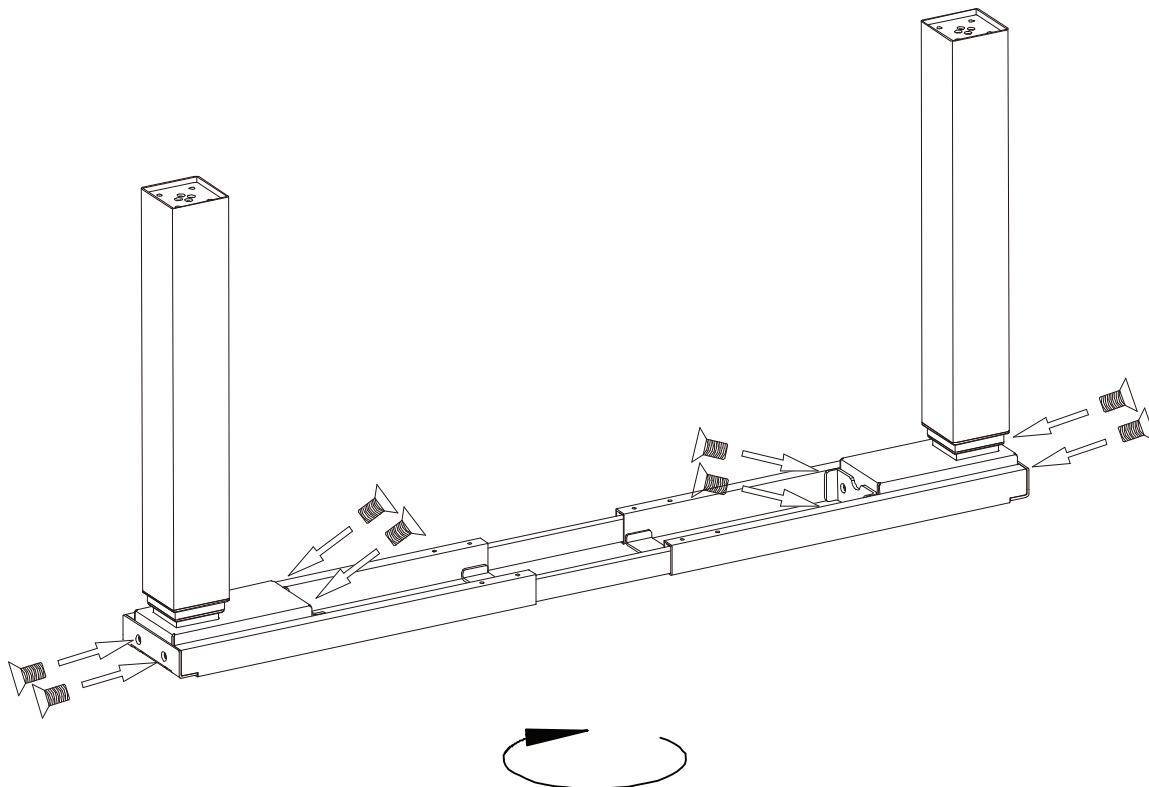

**ŠROUB M6x12 8ks**

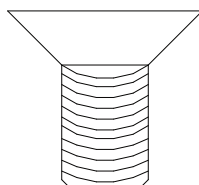

**IMBUSOVÝ KLÍČ 4MM**

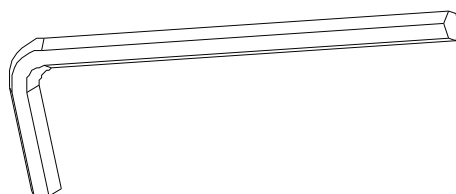

# 3.KROK

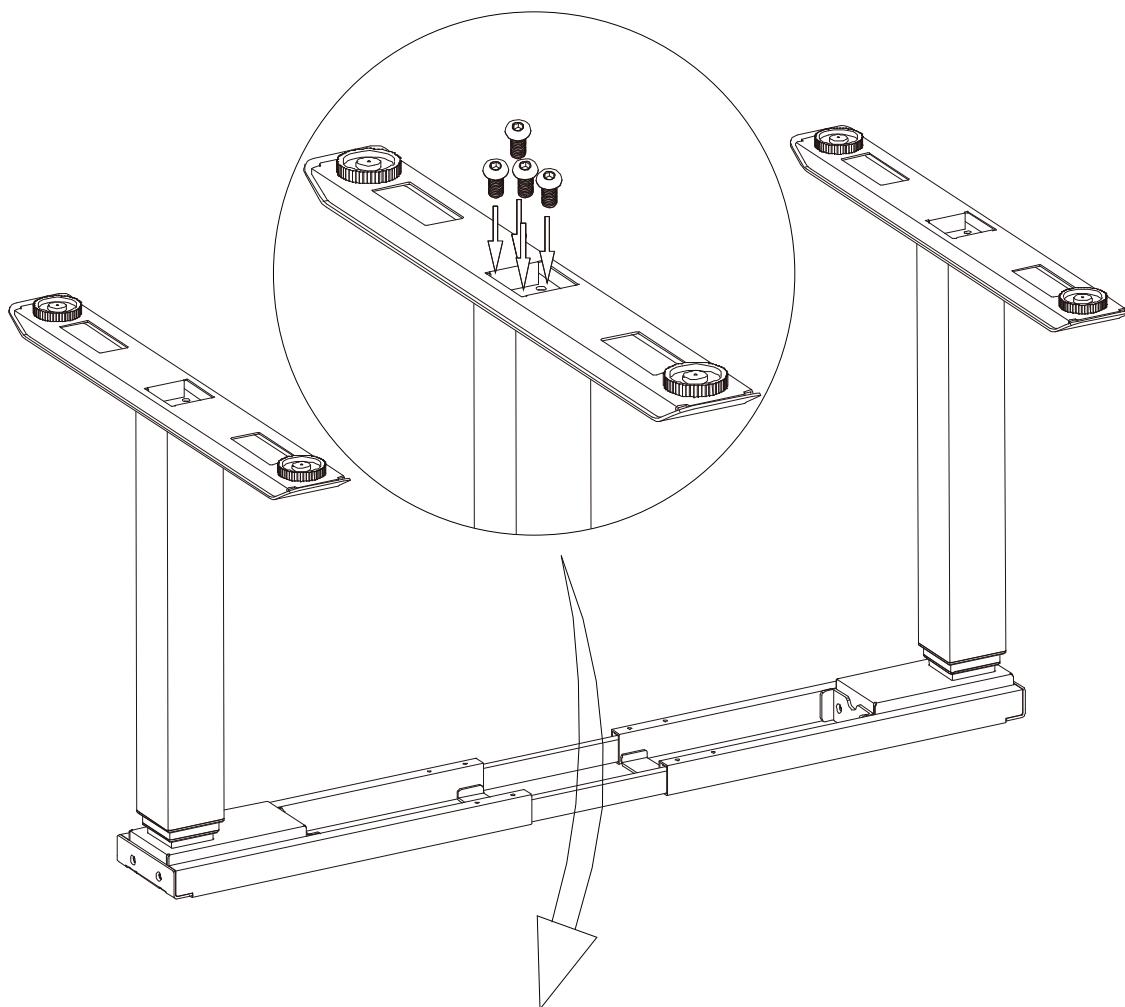

**ŠROUB M8x16 8ks**

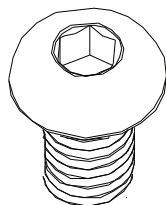

**IMBUSOVÝ KLÍČ 5MM**

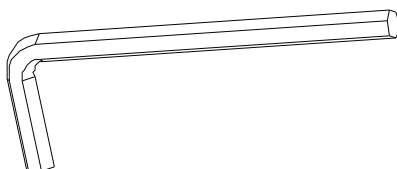

## 4. KROK

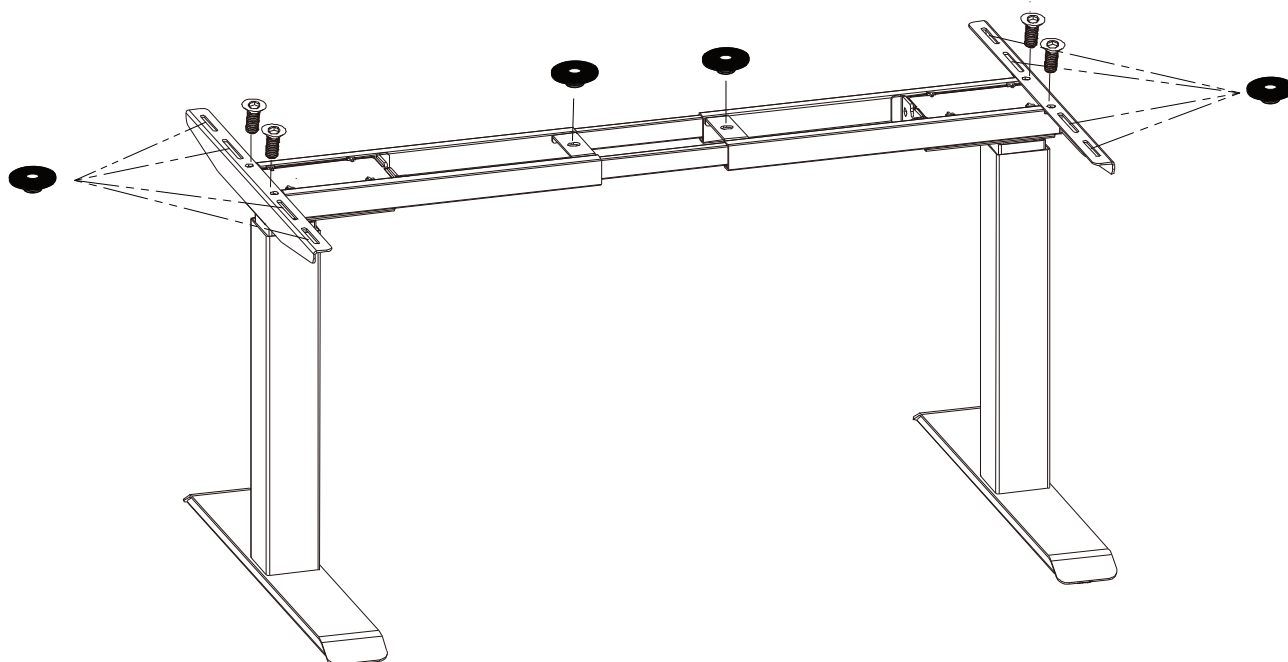

GUMOVÁ PODLOŽKA 10KS

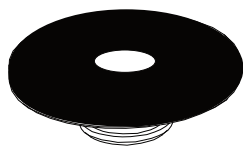

ŠROUB M6x12 4ks

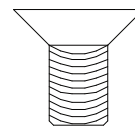

IMBUSOVÝ KLÍČ 4MM

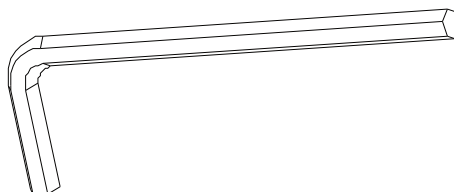

# 5. KROK

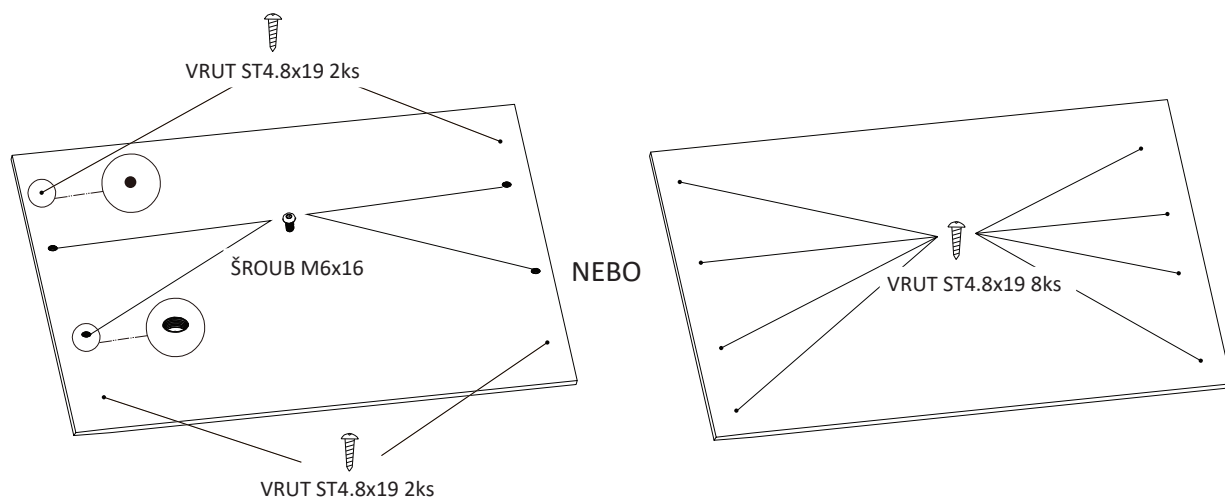
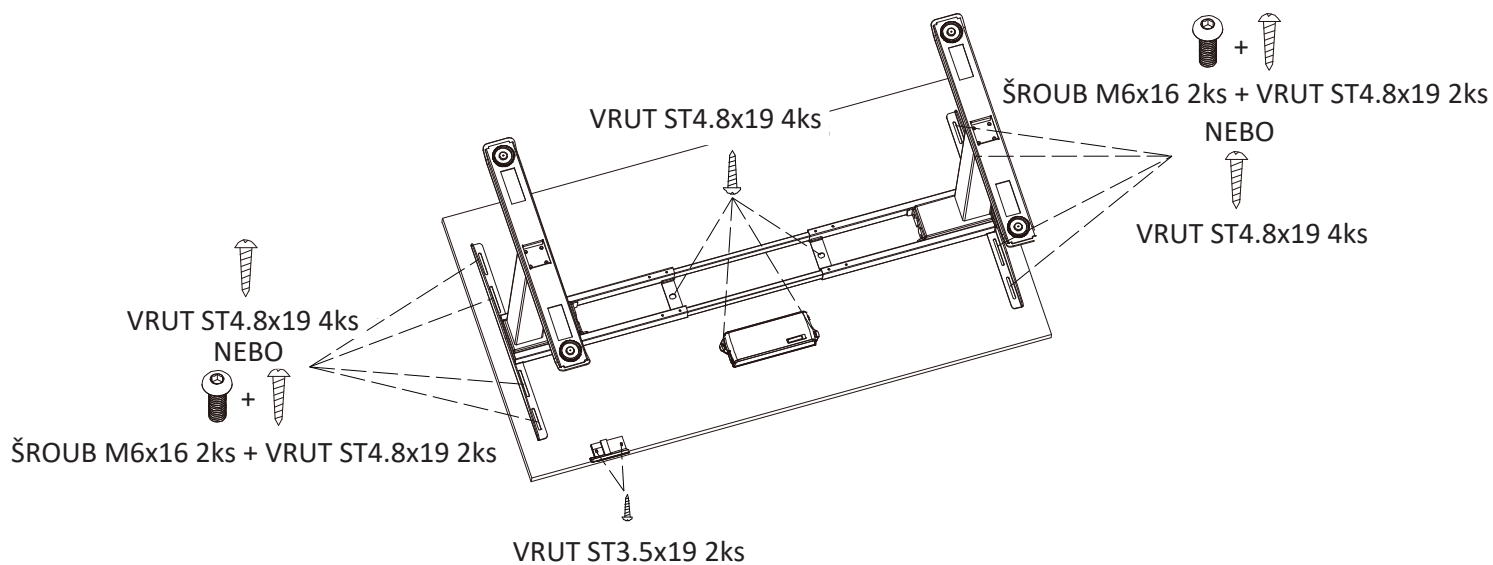

Nepoužívejte vruty ST4.8x19 pro stolovou desku, která je tenčí než 20 mm.

## 6.KROK

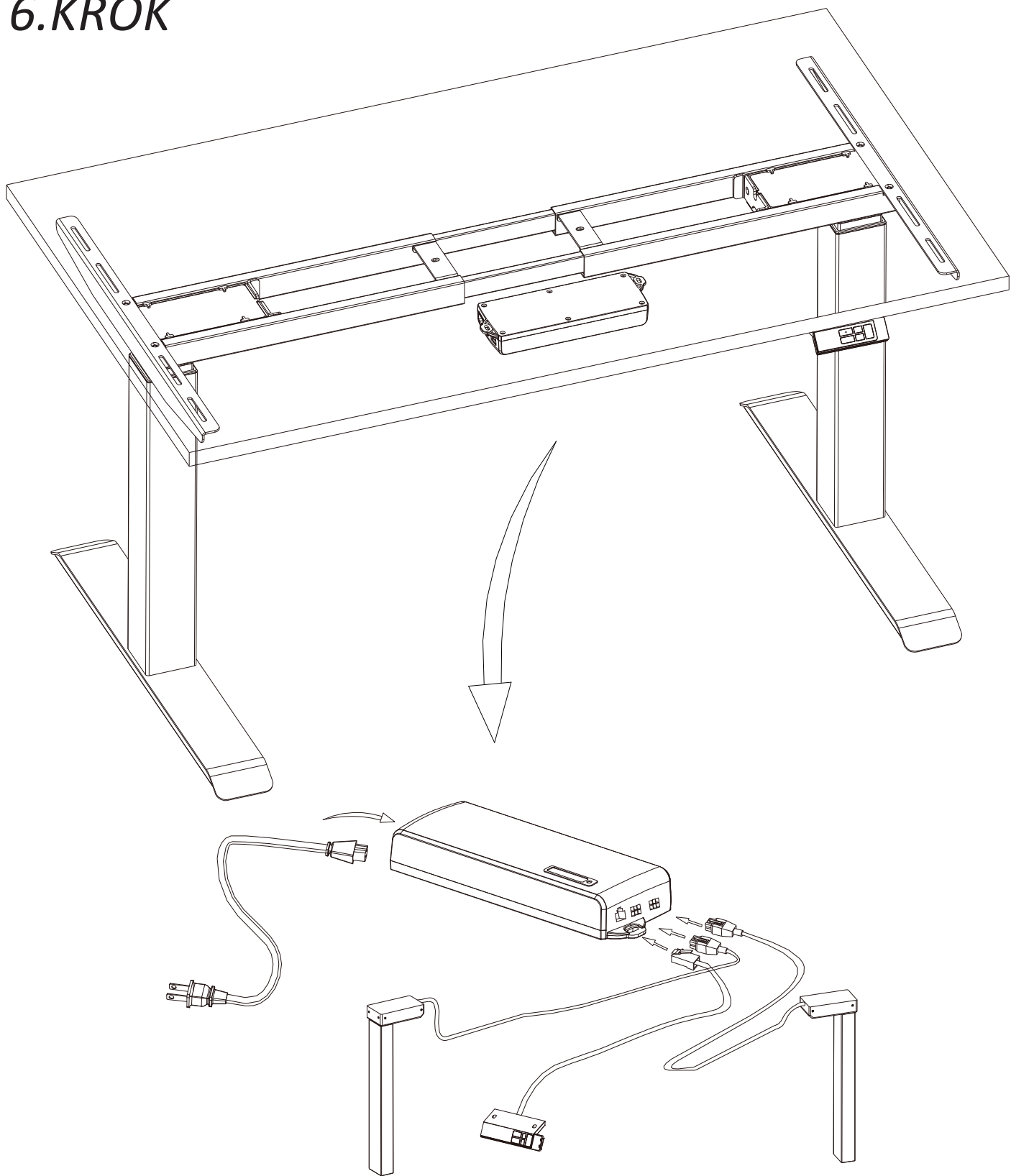

MAX.  
**120**  
KG

VRUT ST3.5x19 5ks



PŘÍCHYTKA KABELŮ

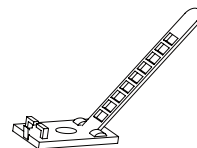

Bluetooth ovládání přes aplikaci "Stand Up Pls." dostupné na App Store nebo Google Play Store.